

Barracuda Condos

Madison, WI

Experience luxurious living just steps away from the best that downtown Madison has to offer at The Barracuda. The six story building is home to 19 unique 2 bedroom, 2 bathroom units. Located in the desirable Basset Street neighborhood, the community is just one block from both Lake Monona and the Wisconsin State Capitol. The Barracuda offers modern new condominium homes with huge windows, upscale kitchens, and winter gardens and sleeping porches. Floor plans range between 1,400 and 1,731 square feet.

5 Parks 

15+ Coffee Shops 

8 Museums 

2 Libraries 

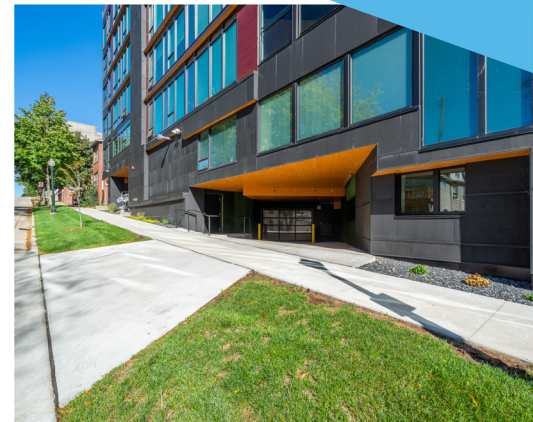

The Barracuda offer breathtaking views of the Wisconsin State Capitol building, Madison cityscape, and Lake Monona. The living area is expansive with 10 foot ceilings and efficient floor-to-ceiling windows. Chef-inspired kitchens boast quartz countertops, wood or steel cabinets, breakfast bars and upgraded Sub Zero appliance packages with an open floor plan that is perfect for entertaining. These condo homes include winter garden and sleeping porches that open up into the living space, offering even more room to spread out all year round. Upper units include beautifully landscaped terraces. Bedrooms are spacious, and include walk-in closets and in-unit laundry. Other features include 8 foot solid core doors, Cat 5 wiring, and perimeter heat at the windows. The Barracuda includes elevator access, a secure underground parking garage with assigned parking, nearby access to the bus line, and is a pet-friendly community. The unbeatable location is just a short walk to the lake, the Overture Center, the Monona Terrace, the Dane County Farmer's Market, the Sylvee, and countless bars and restaurants. At the Barracuda, location and luxury come together to create a unique living experience.

Schools

Randall Elementary
1802 Regent St

Hamilton Middle School
4801 Waukesha St

West High School
30 Ash St

Mad City Dream Homes, RE/MAX Preferred
1619 Monroe St, Suite 1
Madison, WI 53711